

# 3M™ Tegaderm™ I.V. Advanced Securement Dressing

Comprehensively designed to help you deliver exceptional patient care through advanced catheter securement, enhanced wear time and gentle removal.

## Waterproof, sterile barrier

Highly breathable, transparent film protects against external contaminants.\*

## Documentation label

Easily record dressing change information.

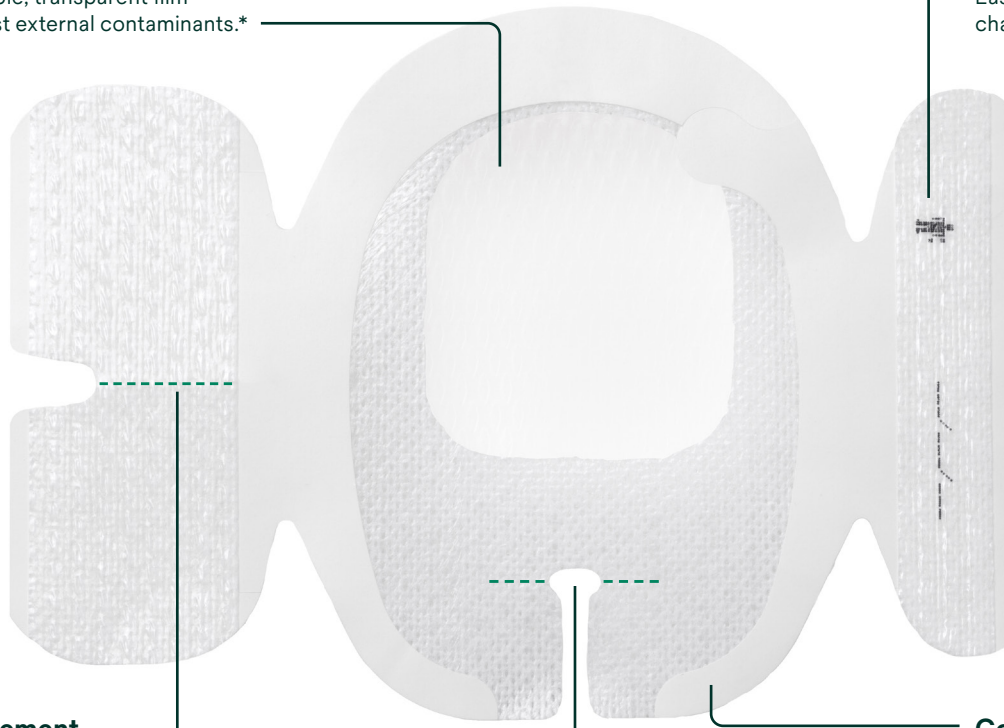

## Large securement tape strip with notch

Promotes consistent application and enhances stabilization. Perforations aid with dressing removal.

## Conforming edge border

Uses technology designed to reduce edge-lift.

## Conforming keyhole notch

A keyhole notch\*\* allows catheter lumens to fit better and stay in place. Perforations\*\*\* allow keyhole notch to conform around a wide variety of catheter sizes and types.

Also available with Chlorhexidine Gluconate (CHG) antimicrobial protection.

3M™ Tegaderm™ CHG Chlorhexidine Gluconate I.V. Securement Dressing 1657

**View product details**

\*\*No keyhole on 1688 dressing notch.  
 \*\*\*No keyhole notch perforations on 1689 dressing.

## Site visibility

Transparent dressing enables early identification of complications at the insertion site.

## Catheter securement

Designed to minimize catheter movement and dislodgement. These dressings meet the Infusion Nurses Society definition of an Integrated Securement Device (ISD).<sup>1</sup>

## Ease of use

Frame delivery makes placement accurate and easy for consistent application. The perforated securement tape strip enables simple, all-at-once removal of the dressing.

## Patient comfort

Safe to wear up to seven days, potentially reducing the number of dressing changes and restarts.

\**In vitro* testing shows that the film provides a barrier against viruses 27 nm in diameter or larger while the dressing remains intact without leakage.  
 1. Nickel B, Gorski LA, Kleidon TM, et al. Infusion therapy standards of practice. *J Infus Nurs.* 2024;47(suppl1):S1-S285. doi:10.1097/NAN.0000000000000532

Compatible with a wide range of vascular access devices:

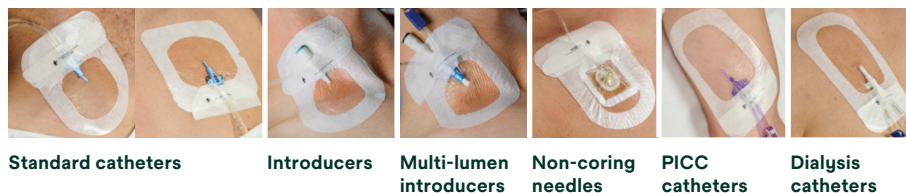

## Application and removal

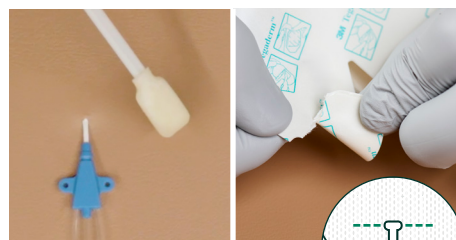

### 1. Prepare

Prepare site according to facility protocol. Ensure site is completely dry. If applicable, open perforations in keyhole notch before removing dressing liner. Peel and remove liner from the dressing.

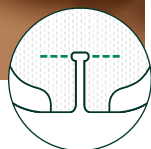

### 2. Press

Place the dressing window over insertion site, aligning extension tubing with securement tubing. Do not stretch the dressing at placement. Apply firm pressure to entire dressing with one hand for optimal adhesion, while removing border frame with opposite hand.

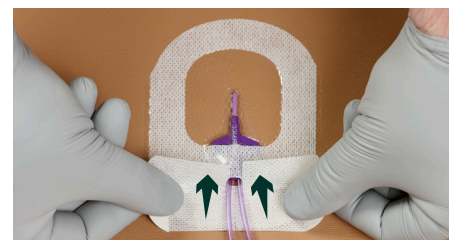

### 3. Secure

Apply securement tape strip under the catheter lumen(s) and overlap back onto the dressing. Remove adhesive-free tabs.

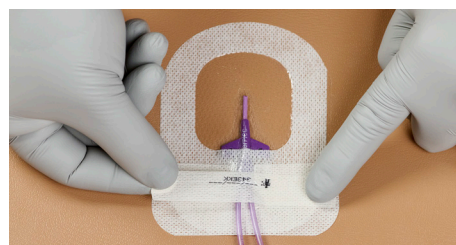

### 4. Secure

Document the dressing change information on the label strip. Apply label strip on top of dressing, over catheter lumen(s). Remove adhesive-free tabs. Secure tubing with tape.

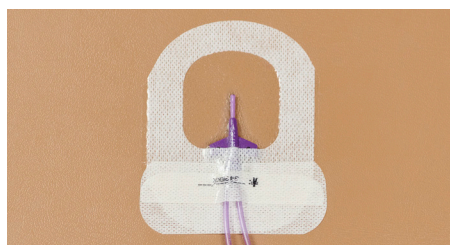

### 5. Monitor

Change the dressing:

- At least every seven days
- If the dressing becomes loose, soiled or damp
- According to facility protocol

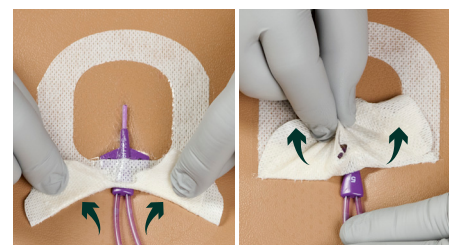

### 6. Removal

Stabilize catheter during dressing removal. Tear open perforation on securement strip to enable removal of all tape strips together. Using a low and slow removal technique, start removing the dressing from where the catheter or tubing exits the dressing toward the catheter insertion site. Avoid skin trauma by peeling the dressing back rather than pulling it up from the skin.

## Ordering information

Product	Product number	Overall dressing size	Dressings/box	Boxes/case
	1685	8.5 cm x 11.5 cm 3 1/2 in. x 4 1/2 in.	50	4
	1688	10 cm x 12 cm 4 in. x 4 3/4 in.	50	4
	1689	10 cm x 15.5 cm 4 in. x 6 1/8 in.	25	4

**More resources**

Scan QR code to view the application and removal video and other product training information.

[Go.Solventum.com/Teg-IV-Adv](https://www.solventum.com/Teg-IV-Adv)

Refer to product Instructions for Use for other important information: [eifu.solventum.com](https://www.eifu.solventum.com)

**NOTE:** Specific indications, contraindications, warnings, precautions, and safety information exist for these products and therapies. Please consult a clinician and product Instructions for Use prior to application.